

SPECIFICATIONS	STAGE	RATIO	PMS042	PMS060	PMS070	PMS090	PMS120	PMS150	PMS180	PMS220	
Nominal Output Torque (N.m)	1	3	-	44	48	168	260	476	987	1560	
		4	35	54	60	188	306	560	1280	2200	
		5	34	48	56	180	292	536	1248	2360	
		7	30	46	52	176	285	520	1185	1880	
		10	22	44	48	168	260	476	987	1560	
	2	12	-	44	48	168	260	476	987	1560	
		15	-	44	48	168	260	476	987	1560	
		16	35	54	60	188	306	560	1280	2200	
		20	34	48	56	180	292	536	1248	2360	
		21	-	44	48	168	260	476	987	1560	
		25	34	48	56	180	292	536	1248	2360	
		28	30	46	52	176	285	520	1185	1880	
		30	-	44	48	168	260	476	987	1560	
		35	30	46	52	176	285	520	1185	1880	
		40	22	44	48	168	260	476	987	1560	
		50	22	44	48	168	260	476	987	1560	
		70	22	44	48	168	260	476	987	1560	
		3	100	34	48	56	180	292	536	1248	2360
	Peak Output Torque (N.m)	1, 2, 3	3-100	3 Times of Nominal Output Torque							
Backlash (arc min)	1	3-10	≤5	≤5	≤5	≤5	≤5	≤5	≤5	≤5	
	2	12-100	≤8	≤8	≤8	≤8	≤8	≤8	≤8	≤8	
Nominal Input Speed (RPM)	1, 2	3, 4, 5	3300	3300	3300	2600	2300	2200	1500	1500	
		7, 10	4000	4000	4000	2900	2800	2800	2400	2000	
		12-40	4400	4400	4400	3200	3000	3000	2800	2400	
		50	4800	4800	4800	3600	3300	3200	3000	2500	
		70	5500	5500	5500	4200	3900	3500	3200	2000	
Torsional Rigidity (Nm/arcmin)	1, 2, 3	3-100	3	6.5	7	14	27	48	115	218	
Allowable Radial Force (N)			700	1400	1400	6200	7500	14000	22000	28800	
Allowable Axial Force (N)			350	800	800	5200	6450	12000	20000	26000	
Service Life (hrs.)			20,000								
Operating Temp. (°C)			-15°C~+90°C								
Protection Class			IP65								
Efficiency (%)	1	2-10	97%								
	2	12-70	94%								
Weights (kg.)	1	3-10	0.40	1.28	1.40	4.10	6.30	18.00	38.00	70.00	
	2	12-70	0.50	1.60	1.80	5.30	7.90	25.00	50.00	78.00	

Gearbox Inertia data available.

**MAJOR FEATURES & APPLICATIONS:** One-piece design, wide frame sizes, high output torque, high allowable radial load, suitable for automation, bending, cutting machines, tube processing machines, grinding machines, machining center, metal forming machines, packaging machines., etc.

# PMS DIMENSIONS

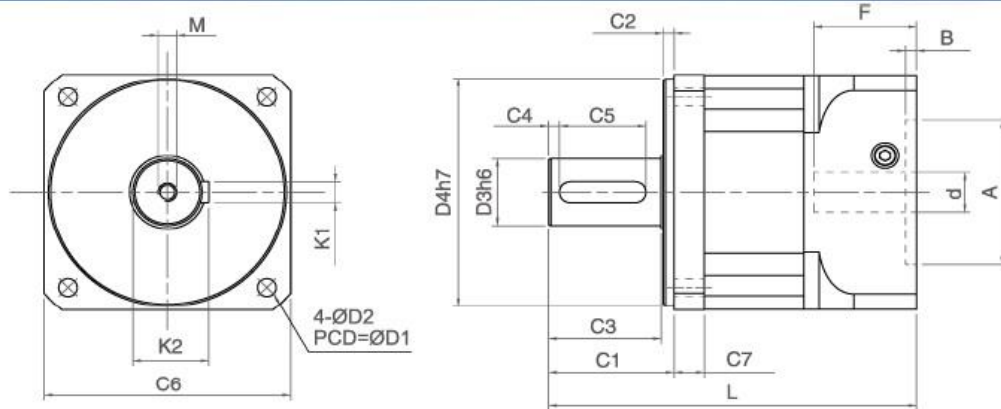

Unit: mm

Size	PMS042	PMS060	PMS070	PMS090	PMS120	PMS150	PMS180	PMS220
D1	50	70	75	105	130	165	215	250
D2	4.2	5.5	5.5	6.8	8.6	10.5	13.0	17.0
D3	12.0	16 (12-16)	20 (16-22)	32 (16-22)	32 (24-35)	42 (38-45)	55 (50-60)	75 (50-75)
D4	35	50	60	80	110	130	160	180
C1	25	35	33	56	58	74	107	124
C2	4	7	5	6	5	4	10	15
C3	20	27	27	49	52	67	96	106
C4	3	3	3	5	5	5	6	7
C5	12	20	20	25	40	45	70	90
C6	42	60	68	94	114	142	180	220
C7	8	15	17	17	19	18	20	30
M	M4 x P0.7x15	M4xP0.7x15	M4xP0.7x15	M6xP1.0x20	M8xP1.25x27	M12xP1.75x32	M12xP1.75x40	M14xP2.0x40
K1	4	5	5	6	10	12	14	20
K2	13.5	18.0	18.0	22.5	35.1	45.0	58.5	79.5
d	≤8	≤14	≤14	≤24	≤28	≤42	≤55	≤69
A	22-30	30-50	30-0	50-80	55-110	95-130	95-155	180-250
B	5	6	6	6	5	10	11	12
F	≤25	≤35	≤35	≤47.5	≤47.5	≤66.5	≤82.5	≤88.5
L1	96.9	125.7	125.7	167.0	170.3	262.0	334.0	356.0
L2	111.4	147.7	147.7	195.3	198.6	313.8	416.0	462.5